

2

Westbound Closure at I-5 Interchange

Target Closure Dates *

- May 31 - June 9**
- 8 days

** See overlap with Stage 3 Closure starting June 3

Designated Detour:

I-5 North to Exit 195 (Beltline) - Follow Signs

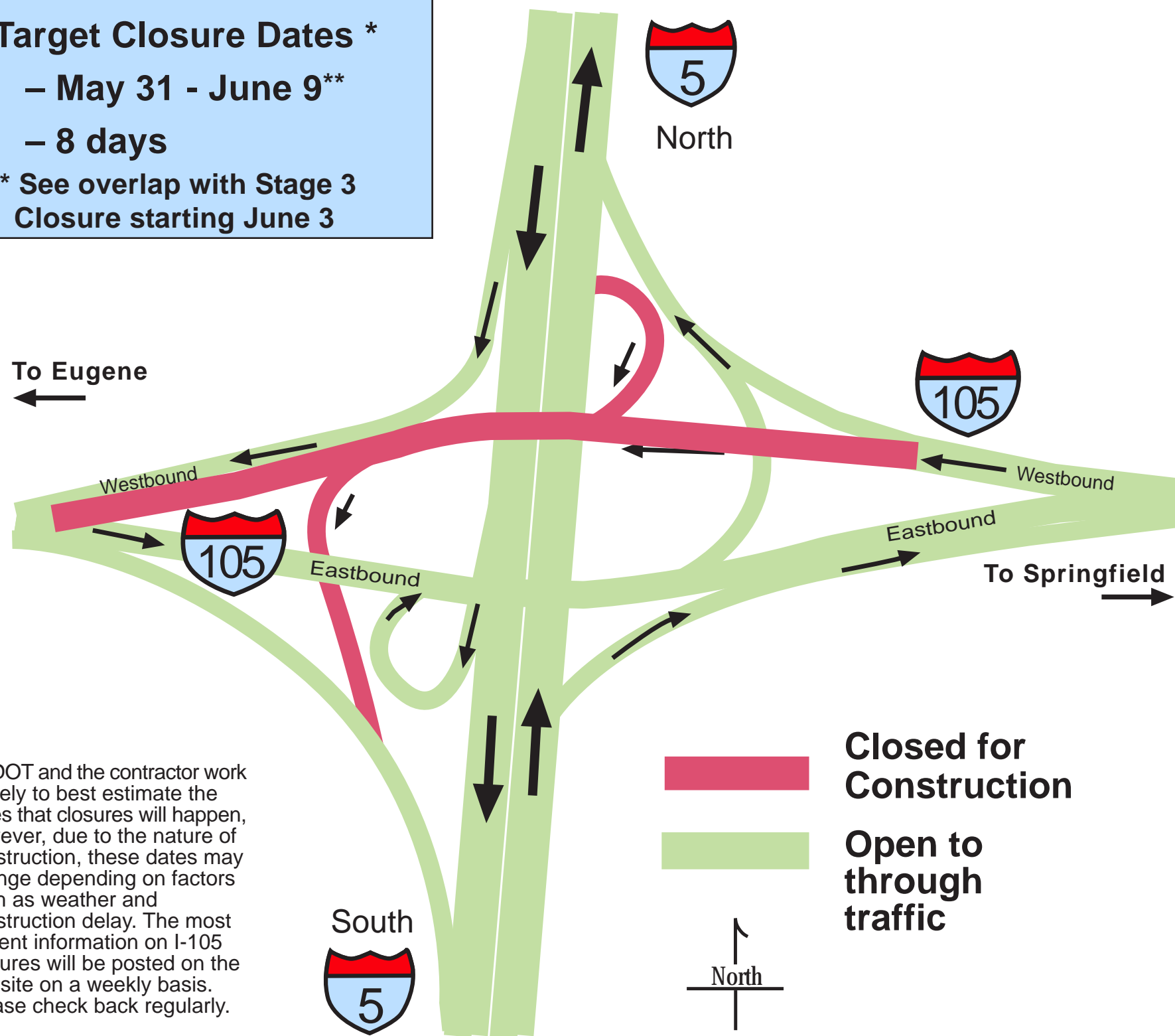

* ODOT and the contractor work closely to best estimate the dates that closures will happen, however, due to the nature of construction, these dates may change depending on factors such as weather and construction delay. The most current information on I-105 closures will be posted on the website on a weekly basis. Please check back regularly.

Suggested Alternate Routes:

- I-5 to Beltline Hwy.
- Pioneer Pkwy.
- Franklin Blvd.
- Harlow Rd.
- Centennial Blvd.

How Traffic Will Be Affected:

I-105 From Downtown Eugene

- * Westbound travel—west of I-5 interchange—will be open, but will experience delay and congestion
- * Both lanes of eastbound travel will be open, but will experience delay and congestion

From I-5

- * All lanes of northbound and southbound I-5 traffic will be open, but expect increased congestion
- * Northbound traffic on I-5 will not be able to take the westbound Eugene exit at I-105/Hwy 126. Detour Eugene Exit 192 Franklin Blvd.

From Springfield (Hwy 126/I-5 interchange - near Gateway)

- * Westbound traffic on Hwy 126 will not be able to merge south onto I-5
- * Westbound traffic on Hwy 126 will not be able to drive the I-5 overpass toward Eugene

For the latest info on closures:
www.keepusmoving.info